

## Mask overview

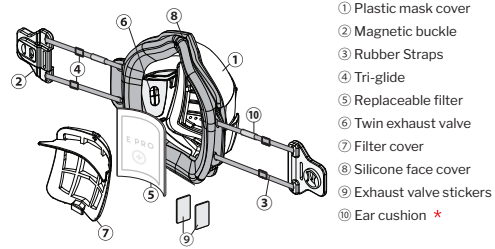

## Note:

\* Stickers are for sealing off exhaust valve to prevent the wearer from contaminating others.

## Adjusting Straps

To adjust length of the strap, pull the strap & move the ④ tri-glide to the left or right to suit user preference.

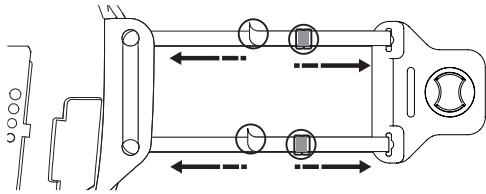

## How to change filter

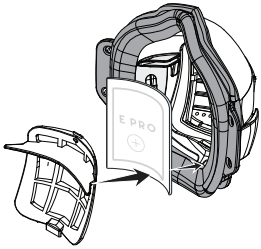

- 1 Pull out filter compartment cap & insert filter cartridge with blue side facing outward from user's face.
- 2 Close back the filter compartment cap by inserting the bottom first and push forwards until you hear a click.

## CAUTION:

- 1 eGee-Pro Refill Filter service life is for daily single usage and is limited by considerations on hygiene, damage to the mask, and increase in breathing resistance.
- 2 Ensure your hands are clean before holding filter cartridge.
- 3 Sanitize the reusable plastic protective mask cover before re-using.

## How to sanitize eGee-Pro Mask

## 1. Using soap/detergent sanitizing (OPTION 1)



Wash your mask in clean warm (around 30C) soapy water, making sure your rinse all components thoroughly before allowing them to dry naturally

## 2. Hot water sanitizing (OPTION 2)



Heat the water to boil & put the plastic reusable face mask in water for 5 ~ 10 minutes to sanitize

## 3. UV light sanitizing (OPTION 3)



Place the plastic reusable face mask with it back expose into UV light range for 15 Min, flip the mask to the front position and let it expose to UV light for another 15 minutes to sanitize.

## WARNING:

- 1 Filter cartridges are NOT for reuse. Remove the used filter and replace it with a new filter.
- 2 Not suitable for children use.

## Disclaimer

The user of this product has the sole responsibility to confirm the suitability of the product for its intended purpose and its safe use and we, our subsidiaries and/or affiliates make no representation or warranty in this regard assume no liability. To the extent that the law permits, our liability for any loss or damage that may be incurred as a result the use of or failure of the product is limited to the cost of repairing or replacing the product and does not extend to any loss or damage which may be the caused as a consequence of such use or failure. We, our subsidiaries, and/or our affiliates shall in no event be liable for economic loss or profits, indirect special or consequential damages.

View user guide video by scanning the QR code  
Lihat video panduan pengguna dengan memindai kode QR  
通过扫描QR码查看用户指南视频  
QRコードをスキャンしてチュートリアルビデオを見る



## Panduan pengguna

## Gambaran keseluruhan topeng

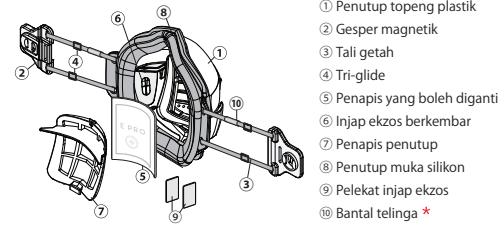

## Note:

\* Stickers are for sealing off exhaust valve to prevent the wearer from contaminating others.

## Adjusting Straps

To adjust length of the strap, pull the strap & move the ④ tri-glide to the left or right to suit user preference.

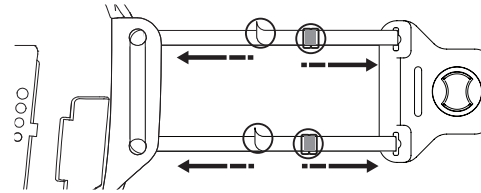

## How to change filter



- 1 Pull out filter compartment cap & insert filter cartridge with blue side facing outward from user's face.
- 2 Close back the filter compartment cap by inserting the bottom first and push forwards until you hear a click.

## CAUTION:

- 1 eGee-Pro Refill Filter service life is for daily single usage and is limited by considerations on hygiene, damage to the mask, and increase in breathing resistance.
- 2 Ensure your hands are clean before holding filter cartridge.
- 3 Sanitize the reusable plastic protective mask cover before re-using.

## How to sanitize eGee-Pro Mask

## 1. Using soap/detergent sanitizing (OPTION 1)



Wash your mask in clean warm (around 30C) soapy water, making sure your rinse all components thoroughly before allowing them to dry naturally

## 2. Hot water sanitizing (OPTION 2)



Heat the water to boil & put the plastic reusable face mask in water for 5 ~ 10 minutes to sanitize

## 3. UV light sanitizing (OPTION 3)



Place the plastic reusable face mask with it back expose into UV light range for 15 Min, flip the mask to the front position and let it expose to UV light for another 15 minutes to sanitize.

## WARNING:

- 1 Filter cartridges are NOT for reuse. Remove the used filter and replace it with a new filter.
- 2 Not suitable for children use.

## Disclaimer

The user of this product has the sole responsibility to confirm the suitability of the product for its intended purpose and its safe use and we, our subsidiaries and/or affiliates make no representation or warranty in this regard assume no liability. To the extent that the law permits, our liability for any loss or damage that may be incurred as a result the use of or failure of the product is limited to the cost of repairing or replacing the product and does not extend to any loss or damage which may be the caused as a consequence of such use or failure. We, our subsidiaries, and/or our affiliates shall in no event be liable for economic loss or profits, indirect special or consequential damages.

View user guide video by scanning the QR code  
Lihat video panduan pengguna dengan memindai kode QR  
通过扫描QR码查看用户指南视频  
QRコードをスキャンしてチュートリアルビデオを見る



设备概述

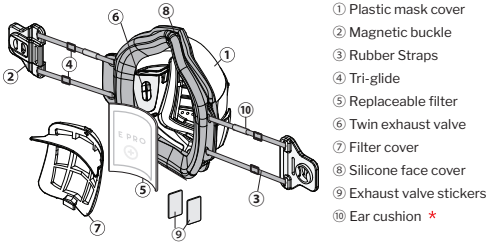

**Note:**  
★ Stickers are for sealing off exhaust valve to prevent the wearer from contaminating others.

Adjusting Straps

To adjust length of the strap, pull the strap & move the ④ tri-glide to the left or right to suit user preference.

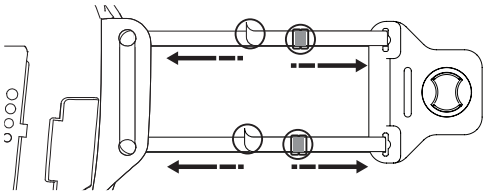

如何更换过滤芯

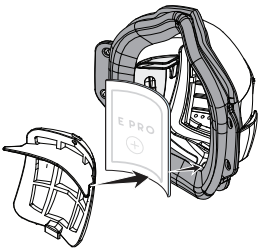

- 1 打开过滤器盖，将过滤器滤芯蓝色面朝下插入。
- 2 盖上过滤器盖时，先插入底部，然后向前推直至听到喀哒一声。

- ⚠ 注意：**
- 1 eGee-Pro 抗菌过滤滤芯的使用寿命建议为每日单次使用，并受到卫生，口罩损坏和呼吸阻力增加等因素的限制。
  - 2 固定滤芯时请确保双手干净。
  - 3 使用前请消毒可重复使用的面罩。

如何消毒eGee-Pro面罩

1. Using soap/detergent sanitizing (OPTION 1)



Wash your mask in clean warm (around 30C) soapy water, making sure you rinse all components thoroughly before allowing them to dry naturally

2. 煮沸(热汤)消毒



使用自来水冲洗塑料面罩。将可重复使用的塑料面罩放入水中煮沸5分钟进行消毒。

3. UV light sanitizing (OPTION 3)



Place the plastic reusable face mask with it back expose into UV light range for 15 Min, flip the mask to the front position and let it expose to UV light for another 15 minutes to sanitize.

- ⚠ 警告：**
- 1 滤芯不可重复使用，请卸下用过的滤芯，更换新的滤芯。
  - 2 不适合儿童使用。

Disclaimer

The user of this product has the sole responsibility to confirm the suitability of the product for its intended purpose and its safe use and we, our subsidiaries and/or affiliates make no representation or warranty in this regard assume no liability. To the extent that the law permits, our liability for any loss or damage that may be incurred as a result the use of or failure of the product is limited to the cost of repairing or replacing the product and does not extend to any loss or damage which may be the caused as a consequence of such use or failure. We, our subsidiaries, and/or our affiliates shall in no event be liable for economic loss or profits, indirect special or consequential damages.

View user guide video by scanning the QR code  
Lihat video panduan pengguna dengan memindai kode QR  
通过扫描QR码查看用户指南视频  
QRコードをスキャンしてチュートリアルビデオを見る



製品本体の概要

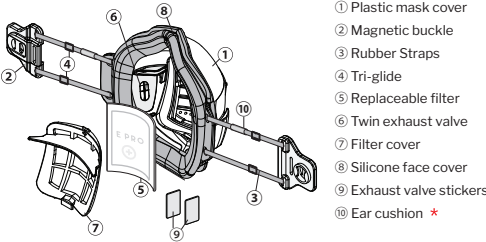

**Note:**  
★ Stickers are for sealing off exhaust valve to prevent the wearer from contaminating others.

Adjusting Straps

To adjust length of the strap, pull the strap & move the ④ tri-glide to the left or right to suit user preference.

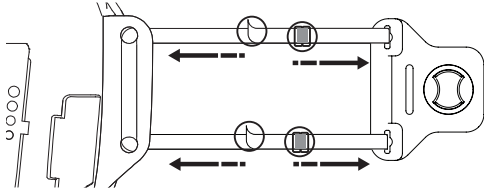

フィルター交換について

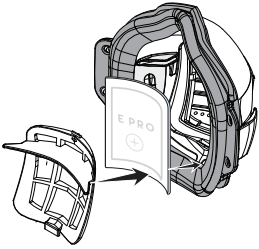

- 1 鼻と口に接する内側のカバーのキャップを取り外し、青い面を手前にしてフィルターをフィットさせます。
- 2 フィルターの上からカバーをします。まず下側から取り付け、カチッ音がするまで押します。

- ⚠ 注意事項：**
- 1 eGee-Pro 抗菌フィルターは、1日1枚の使用が目安ですが、使用する環境の衛生面、ユーザーの呼吸状態によって交換頻度を増やすことをお勧めします。
  - 2 フィルターセットの際は、清潔な手で行って下さい。
  - 3 フェイスマスクは煮沸消毒してからご使用下さい。

マスクの洗い方・煮沸消毒・UV消毒について

1. Using soap/detergent sanitizing (OPTION 1)



Wash your mask in clean warm (around 30C) soapy water, making sure you rinse all components thoroughly before allowing them to dry naturally

2. 煮沸(熱湯)消毒



マスクを軽く水洗いしてから、沸騰したお湯に入れます。5～10分間煮沸消毒し、十分に乾かしてから使用して下さい。

3. UVライト消毒



UVライトが、マスク外側にあたるように置いて15分間減菌します。内側も同じく15分間、UVライトにあてて減菌します。

- ⚠ 注意事項：**
- 1 抗菌フィルターは再利用できません。毎日交換して下さい。
  - 2 このマスクは幼児向きではありません。(マスクサイズは呼吸の滞留時間をなるべく短くするために、小さめに設計されており、小学1年生以上は使用できます。但し、個人差がありますので装着時に違和感や不快感がある、もしくはマスクと装着面に隙間がありフィットしない場合はご使用をおやめください)

Disclaimer

The user of this product has the sole responsibility to confirm the suitability of the product for its intended purpose and its safe use and we, our subsidiaries and/or affiliates make no representation or warranty in this regard assume no liability. To the extent that the law permits, our liability for any loss or damage that may be incurred as a result the use of or failure of the product is limited to the cost of repairing or replacing the product and does not extend to any loss or damage which may be the caused as a consequence of such use or failure. We, our subsidiaries, and/or our affiliates shall in no event be liable for economic loss or profits, indirect special or consequential damages.

View user guide video by scanning the QR code  
Lihat video panduan pengguna dengan memindai kode QR  
通过扫描QR码查看用户指南视频  
QRコードをスキャンしてチュートリアルビデオを見る

